



## Supervisor Collaboration Agenda: Baton Rouge Friday, March 23, 2018

The Supervisor Collaboration events will provide supervisors across Louisiana with high-quality tools, resources and professional development to help them effectively lead in 2017-2018 and plan for 2018-2019.

**Location:**

**Claiborne Building**  
1201 North Third St.  
Baton Rouge, LA 70806

**Parking:**

Parking is available in the lot in front of the Claiborne Building or along the levee. Do not attempt to park in the garage behind the building; this is for state employees only and requires a key card for entry. Parking is limited. Please consider carpooling and leave extra time to walk to the building.

**Agenda:**

8:00 a.m. - 8:30 a.m.	Sign-in ( <i>main foyer</i> )	9:40 a.m. - 10:40 a.m. Session Rotation 2
8:30 a.m. - 9:30 a.m.	Session Rotation 1	10:50 a.m. - 11:50 a.m. Session Rotation 3

**Preparation**

All participants should **bring a fully charged laptop computer** with them to the event and [download session materials in advance](#).

**Food and Hotels**

Food will *not* be provided at the event. Click here for a list of [Baton Rouge area hotel and food options](#).

**Contact Us**

Please contact your Network support team or [DistrictSupport@la.gov](mailto:DistrictSupport@la.gov) with questions about this event.



**Sessions**

Participants will have the opportunity to choose **three** sessions that fit their needs and interests. Attendees from each LEA should coordinate with one another to ensure they get all the necessary information. All sessions are filled on a first come, first served basis.

Session Topics	Session Title	Session Description	Rotation(s)	Room
School System Planning	<b>School Redesign: Implementation Support</b>	In this session, participants will receive guidance on how to implement their approved school redesign plans and learn about support that will be provided by the LDOE. Please ensure supervisors of workforce planning and academics (curriculum, assessment, and PD) attend this session.	1, 2	LA Purchase Room 1-100
Assessment: LEAP 360	<b>Leaping Forward: A Sneak Peek at LEAP 360 Enhancements Planned for 2018-2019</b>	LEAP 360 feedback was collected throughout the 2017-2018 school year, and based on that feedback, several enhancements are planned for the 2018-2019 school year. While full details about all enhancements will be provided throughout the spring and at the annual Teacher Leader summit, this sneak peek will highlight the types of enhancements that will be available for 2018-2019.	3	LA Purchase Room 1-100
Data Systems	<b>2018-2019 Proposed Enhancements for LDE Application Systems</b>	In this session, participants will walk through a summary of the current year data submissions and what's required to close out the year. There will also be a review and discussion of data systems changes being requested for the 2018-19 school year.	2	Thomas Jefferson Room 1-136C
Instruction: Assessment Development	<b>LEAP 2025: Assessment Development and the Role of Committees</b>	Ever wonder how the items on a test get there? This session will take supervisors through the development process and highlight on the vital role of review committees. Supervisors will leave with an understanding of assessment development and a plan to help the LDOE recruit committee members for 2018-2019 committees.	1	Thomas Jefferson Room 1-136C

Session Topics	Session Title	Session Description	Rotation(s)	Room
Instruction: Special Education	<b>Science Connectors for Students with Significant Disabilities</b>	The department is currently in the process of developing Louisiana Connectors for science for 2018-2019 adoption and implementation. Participants will review the purpose of the Connectors, ensure alignment with both the Louisiana Student Standards in Science (as well as the ELA and Math Connectors), and propose aligned resources for the <a href="#">Science Connectors</a> .	1	Rotation 1: Marbois Room 1-137
			2	Rotation 2: Wyoming Room 1-132
Instruction: ELA	<b>Moving Forward with Guidebooks</b>	The Department is currently in the process of developing supports for diverse learners embedded in the <a href="#">ELA Guidebook</a> units. Participants will leave knowledgeable of the key ELA vendor sessions at the summit and how to access the high quality resources and professional development. Participants will leave the session with a plan of which sessions supervisors, instructional coaches, and teachers should attend to get the most leverage in their district.	2	Thomas Jefferson Room 1-136A
Instruction: Social Studies	<b>Building Strategic Partnerships for Social Studies</b>	Participants, in this session, will leave knowledgeable of the key social studies vendor sessions at the summit and how building strategic partnerships are key to ensuring students have access to high quality materials and teachers have access to high quality professional development.	1	Thomas Jefferson Room 1-136A
Instruction: English Learners	<b>Next Steps: ELPT Results</b>	In this session, participants will preview an ELPT individual student report and will learn how to write learning targets based on the specific domain performance level descriptors.	1	Arkansas Room 1-190
Instruction: Math	<b>Ensuring the Investment in Math Curriculum and PD is Paying off with Students</b>	In this session, participants will identify the top 3 causes for ineffective math instruction, learn about tools we have to support quality implementation, and identify strategies / trainings to address the issues.	2, 3	Thomas Jefferson Room 1-136B

*Note: All of the session information in this table is subject to change.*

Session Topics	Session Title	Session Description	Rotation(s)	Room
Early Childhood	<b>Updates for Community Network Lead Agencies</b>	This session is for early childhood community network lead agencies and will include “need to know” information about proposed policy changes, the new child care civil background check, and the pending request for applications for early childhood community network lead agencies.	1	Iowa Room 1-153
Early Childhood	<b>Strengthening Community Network Partnerships</b>	This session is for early childhood community network lead agencies. Would you like a little more community in your network? Practical suggestions for strengthening strategies to engage and collaborate with your program partners will be discussed. Bring your best ideas for increasing meeting attendance, connecting services and engaging a broader set of stakeholders.	2	Iowa Room 1-153
Early Childhood	<b>Identifying and Promoting Improvement Across Your Network</b>	This session is for early childhood community network lead agencies. How effective are you and your team at looking across the landscape for your community and recognizing improvement? And more importantly, what specific practices are behind the improvement? This session will hone your skills as an “improvement investigator” and give you ideas for promoting and replicating improvement across all programs.	3	Iowa Room 1-153
Federal Policy and Grants: Special Education	<b>How to Fund your Special Education Plan: the IDEA Grant Application</b>	In this session, participants will be introduced to structural changes to the 2018-2019 IDEA Consolidated Application. Participants will engage in a planning activity to think through their school systems' Special Education priorities for the 2018-2019 school year.	1 3	Rotation 1: Thomas Jefferson Room 1-136B  Rotation 3: Thomas Jefferson Room 1-136C

*Note: All of the session information in this table is subject to change.*

Session Topics	Session Title	Session Description	Rotation(s)	Room
Student Opportunities	<b>Graduation Cohort Checklist Update</b>	Participants, in this session, will review the new graduation requirements for the 2018 cohort and the timeline for IGP and FAFSA submission. A review of the basics of the Jump Start Career Diploma credential requirement will be given. Current FAFSA data will be discussed.	1, 3	Wyoming Room 1-132
Talent	<b>Content Leaders and Mentor Teachers: 2018-2019 Nomination Process</b>	<a href="#">Content Leaders</a> specialize in providing content-rich and curriculum-specific professional development for teachers, while Mentor Teachers specialize in coaching pre-service teachers, post-baccalaureate teachers of record, or other teachers in your schools who need support. Both roles promote teacher retention and offer leadership opportunities for your most talented educators. Attend this session to learn how to nominate educators from your district for these widely-acclaimed training series.	2, 3	Arkansas Room 1-190
Talent	<b>2017-2018 Educator Workforce Data in the Secure Site</b>	For this session, participants will be prepared to use the secure site to access and understand their new educator workforce data in order to make critical decisions around 1) recruiting and hiring, 2) retention, promotion, and granting tenure, 3) compensation, and 4) evaluating results.  <b><i>NOTE: Participants should bring a laptop or tablet and be prepared to log into the secure portal.</i></b>	2  3	Rotation 2: Marbois Room 1-137  Rotation 3: Thomas Jefferson Room 1-136A

*Note: All of the session information in this table is subject to change.*

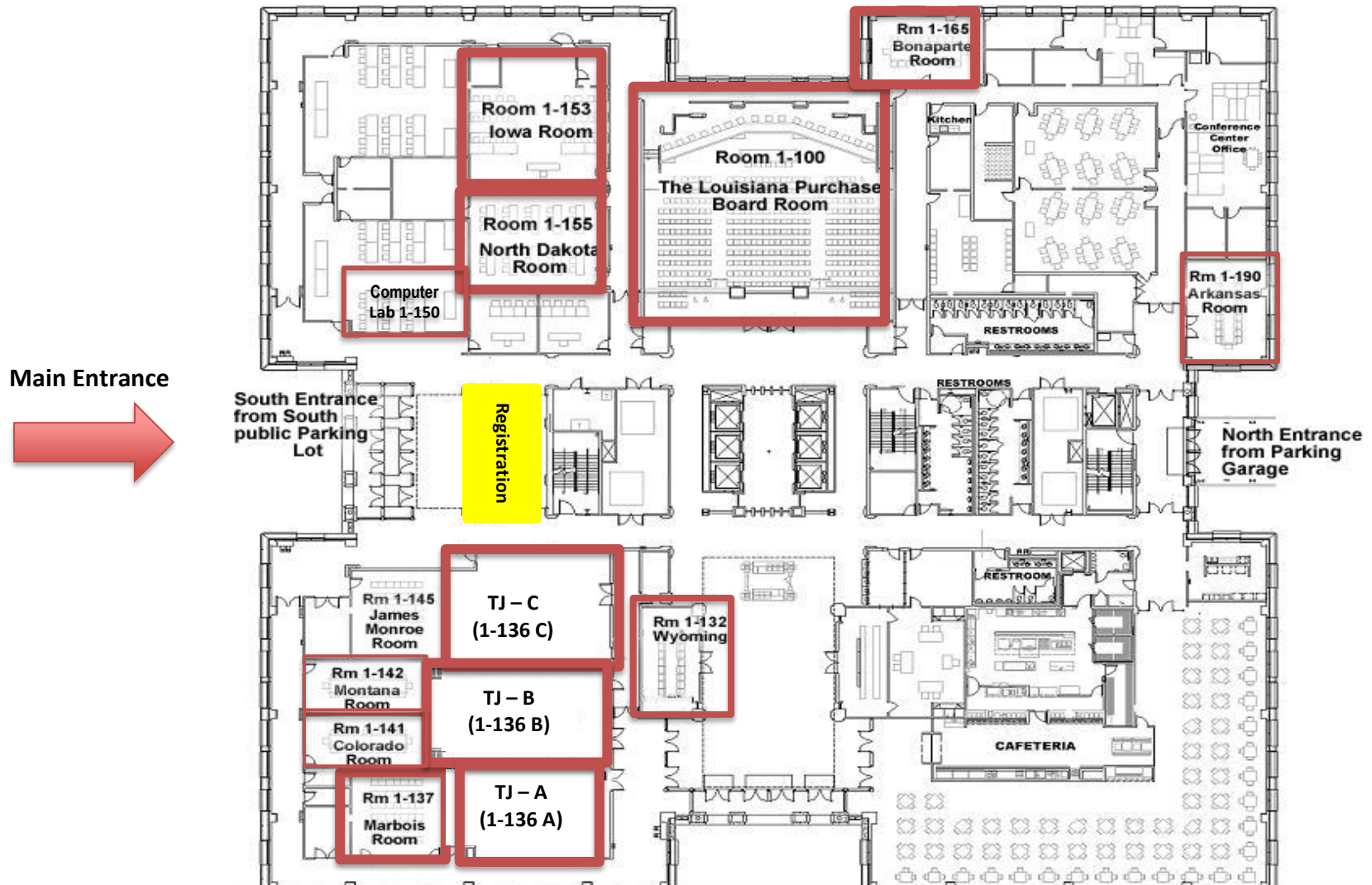

*Note: All of the session information in this table is subject to change.*